

BIN ROOM REQUIREMENT : SPIRAL WASTE BIN SYSTEM WITH REAR BIN LIFTER SYSTEM

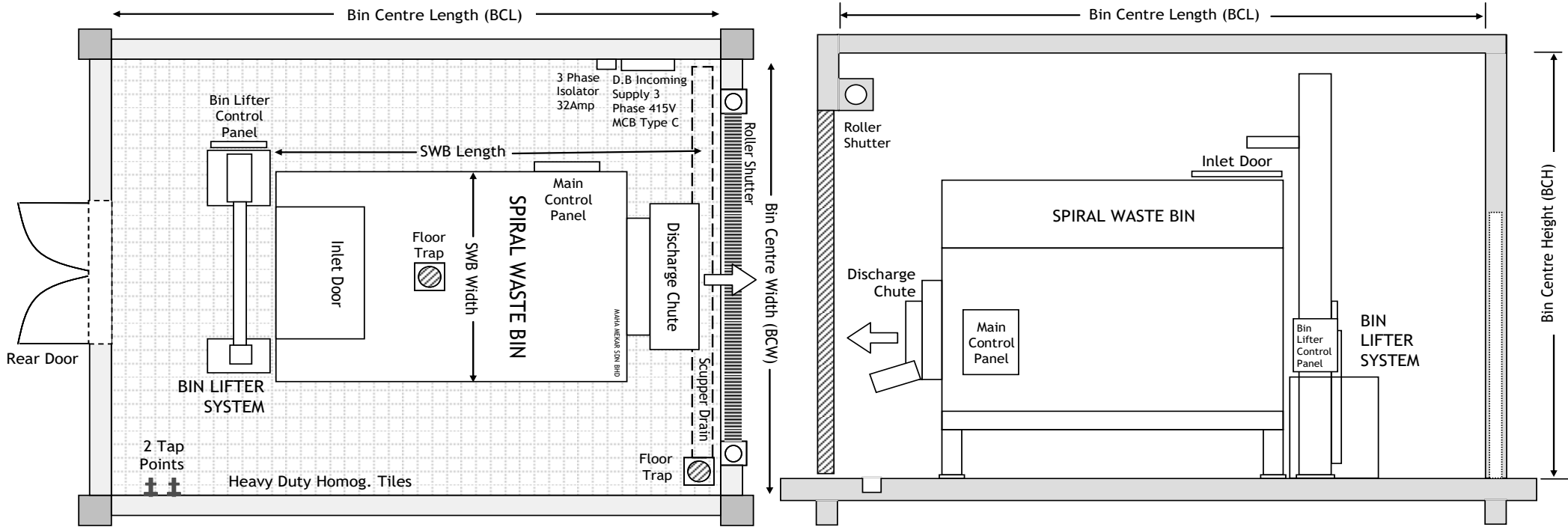

SPIRAL WASTE BIN SPECIFICATIONS						REAR BIN LIFTER SYSTEM			
SPIRAL WASTE BIN SYSTEM						Roller Shutter	BIN ROOM DIMENSION (MIN)		
Model	Volume	Length	Width	Height	Type	Height / Width	BCL	BCW	BCH
SWB-4	4.4 m ³	3095	2220	2745	Single Screw System	4000 / 3700	5500	4150	4150
SWB-6	6.3 m ³	3095	2220	3145	Single Screw System	4000 / 3700	5500	4150	4550
SWB-8	8.2 m ³	3595	2220	3045	Single Screw System	4000 / 3700	6000	4150	4450
SWB-10	10.2 m ³	3595	2220	3395	Single Screw System	4000 / 3700	6000	4150	4800
SWB-12	12.1 m ³	3595	2220	3745	Single Screw System	4000 / 3700	6000	4150	5150
SWB-14S	14.1 m ³	3595	2220	3945	Single Screw System	4000 / 3700	6000	4150	5350
SWB-14D	14.5 m ³	5125	2220	2945	Double Screw System	4000 / 3700	7650	4150	4350
SWB-16D	16.4 m ³	5125	2220	3145	Double Screw System	4000 / 3700	7650	4150	4550
SWB-18D	18.8 m ³	5125	2220	3395	Double Screw System	4000 / 3700	7650	4150	4800
SWB-20D	20.6 m ³	5125	2220	3595	Double Screw System	4000 / 3700	7650	4150	5000
SWB-22D	22.1 m ³	5125	2220	3745	Double Screw System	4000 / 3700	7650	4150	5150
SWB-24D	24.1 m ³	5125	2220	3945	Double Screw System	4000 / 3700	7650	4150	5350

- ### BIN ROOM REQUIREMENTS
- (a) Minimum Bin Room Size According to Table on the Left (Equipped With Roller Shutter)
 - (b) Provision of 3-Phase, 415V, Type C Power Supply Through 32A Isolator Point
 - (c) Provision of Water Supply Through Two (2) Tap Points Located In The Bin Room
 - (d) Provision of a minimum of Two (2) Floor Traps in the Bin Room (Three (3) for Double Screw System)
- Updated : March 2024

SWB System Manufactured & Distributed by :
MAHA MEKAR SDN. BHD.
Tel (03) 7728 3412 Fax (03) 7731 0169
 Please send enquiries to : mahamekar@gmail.com

BIN ROOM REQUIREMENT : SPIRAL WASTE BIN SYSTEM WITH SIDE BIN LIFTER SYSTEM

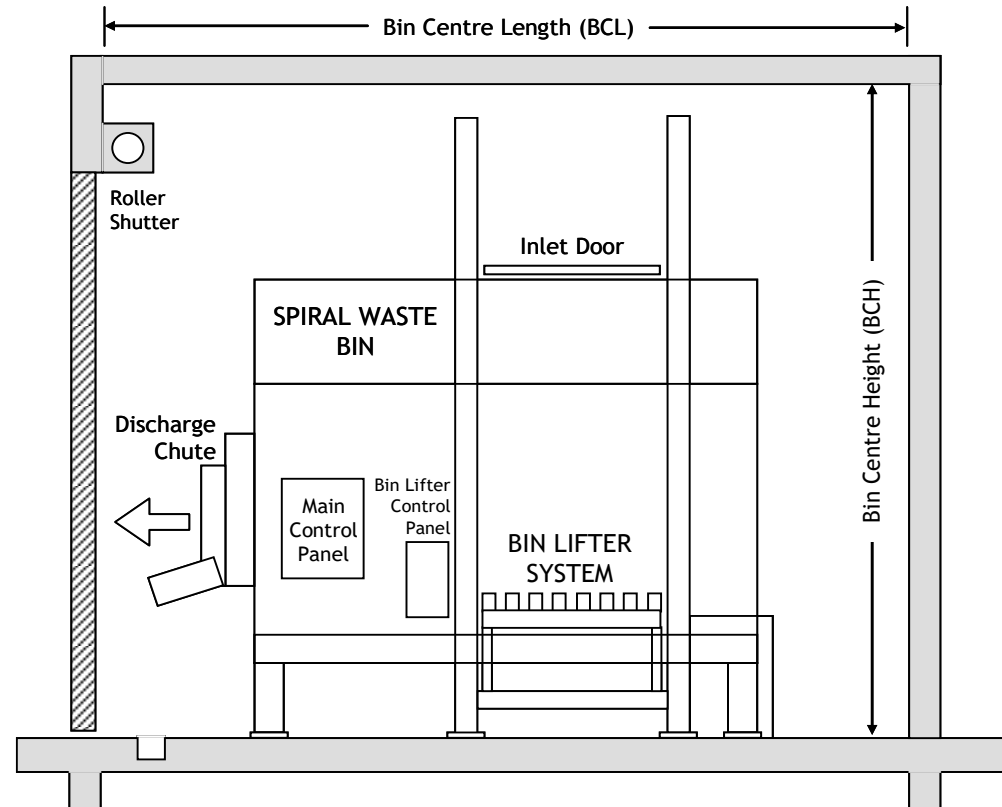
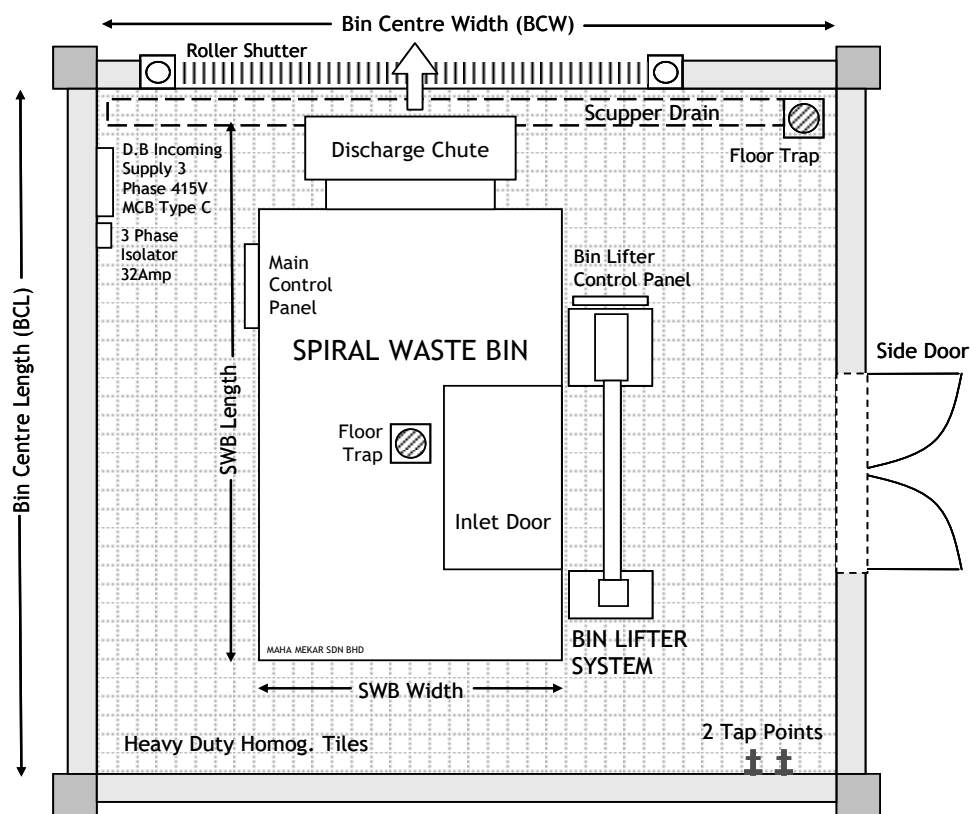

SPIRAL WASTE BIN SPECIFICATIONS						SIDE BIN LIFTER SYSTEM			
SPIRAL WASTE BIN SYSTEM						Roller Shutter	BIN ROOM DIMENSION (MIN)		
Model	Volume	Length	Width	Height	Type	Height / Width	BCL	BCW	BCH
SWB-4	4.4 m ³	3095	2220	2745	Single Screw System	4000 / 3700	4300	5300	4150
SWB-6	6.3 m ³	3095	2220	3145	Single Screw System	4000 / 3700	4300	5300	4550
SWB-8	8.2 m ³	3595	2220	3045	Single Screw System	4000 / 3700	4800	5300	4450
SWB-10	10.2 m ³	3595	2220	3395	Single Screw System	4000 / 3700	4800	5300	4800
SWB-12	12.1 m ³	3595	2220	3745	Single Screw System	4000 / 3700	4800	5300	5150
SWB-14S	14.1 m ³	3595	2220	3945	Single Screw System	4000 / 3700	4800	5300	5350
SWB-14D	14.5 m ³	5125	2220	2945	Double Screw System	4000 / 3700	6350	5300	4350
SWB-16D	16.4 m ³	5125	2220	3145	Double Screw System	4000 / 3700	6350	5300	4550
SWB-18D	18.8 m ³	5125	2220	3395	Double Screw System	4000 / 3700	6350	5300	4800
SWB-20D	20.6 m ³	5125	2220	3595	Double Screw System	4000 / 3700	6350	5300	5000
SWB-22D	22.1 m ³	5125	2220	3745	Double Screw System	4000 / 3700	6350	5300	5150
SWB-24D	24.1 m ³	5125	2220	3945	Double Screw System	4000 / 3700	6350	5300	5350

BIN ROOM REQUIREMENTS

- (a) Minimum Bin Room Size According to Table on the Left (Equipped With Roller Shutter)
- (b) Provision of 3-Phase, 415V, Type C Power Supply Through 32A Isolator Point
- (c) Provision of Water Supply Through Two (2) Tap Points Located In The Bin Room
- (d) Provision of a minimum of Two (2) Floor Traps in the Bin Room (Three (3) for Double Screw System)

Updated : March 2024

SWB System Manufactured & Distributed by :

MAHA MEKAR SDN. BHD.

Tel (03) 7728 3412 Fax (03) 7731 0169

Please send enquiries to : mahamekar@gmail.com